

ASTM CATEGORY 1 : road only  
 Maximum tyre pressure: 2.55bar/37PSI with a 54mm tyre - 1.3bar/19PSI with a 125mm tyre  
 For a longer longevity of the wheel, Mavic recommends that the total weight supported by the wheels don't exceed 120kg, bike included  
 Maximum tyre pressure: 7.5bar/108PSI with a 23mm tyre - 4.6bar/67PSI with a 52mm tyre  
 Recommended tyre sizes: 25 to 32 mm  
 Max. Pressure: see indication on wheel and tyre. If they differ, use the lower of the 2  
 Max. Pressure: 23mm 8.7 bars - 125 psi, 25/28mm 7.7 bars - 110 psi  
 Maximum tyre size: width 52mm - pressure max. 5Bar/72PSI

REFERENCES WHEELS

R23241    AKSIUM RB 700 QR M11

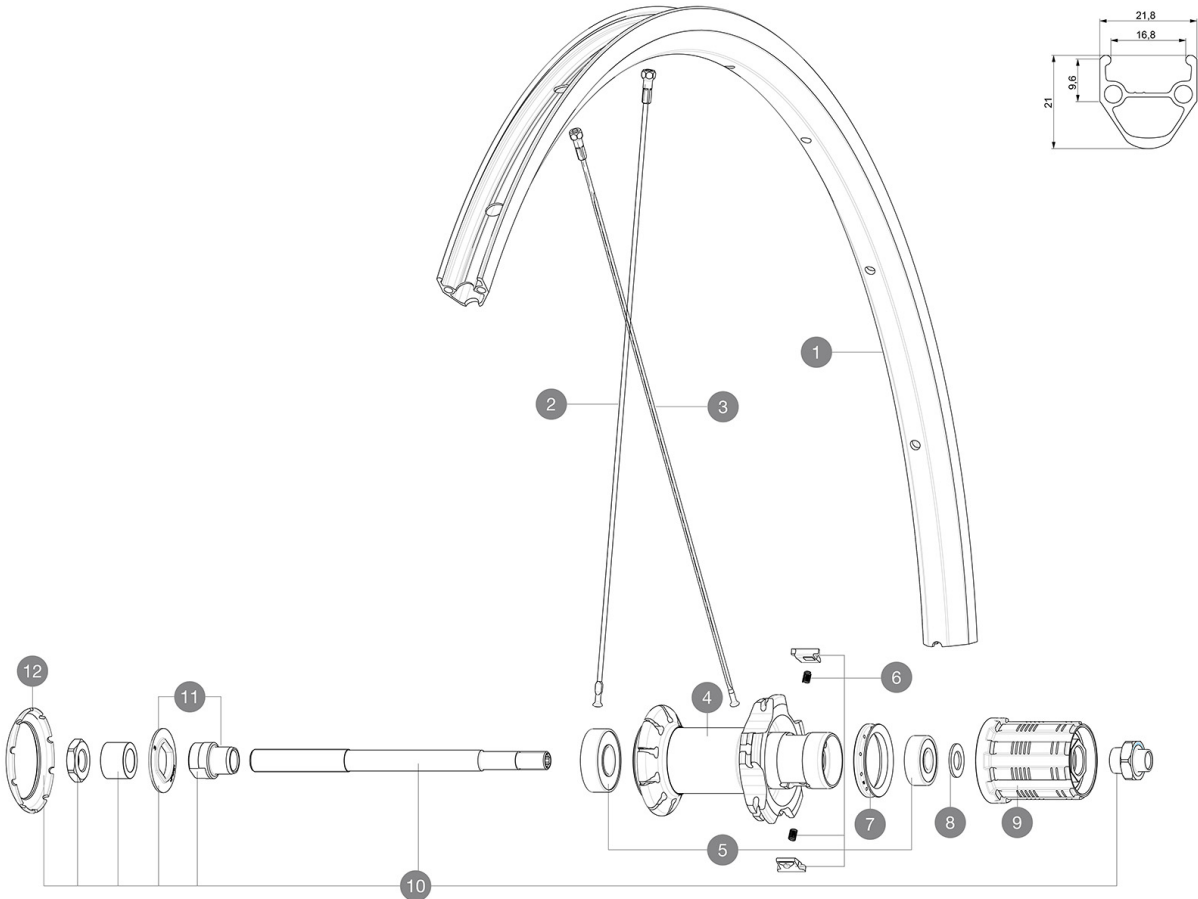

RIMS



|   |                |                  |
|---|----------------|------------------|
| 1 | jantearrouteub | REAR ROAD UB RIM |
|---|----------------|------------------|

SPOKES

|   |          |  |
|---|----------|--|
| 2 | V2272701 | KIT 10 FT/NDS AKSIUM RND SPK 283mm (OEM only)  |
| 3 | V3661501 | KIT 10 DS AKSIUM 19 FLAT SPOKE 301mm + nipples |

HUB SHELLS

|    |          |   |
|----|----------|---|
| 5  | M40660   | REAR HUB 608+6001 BEARINGS                    |
| 6  | M40578   | FTSL PAWLS KIT (ROAD WHEELS)                  |
| 7  | 99500001 | FTSL/FTSX FREEHUB BODY SEAL                   |
| 8  | M40067   | INTERNAL FREEWHEEL SPACER FTSL/FTSX           |
| 9  | 30871101 | FTS-L ROAD FREEWHEEL BODY HG11 8/9 compatible |
| 10 | 99603901 | REAR AXLE QRM ROAD 2008                       |
| 11 | 99603801 | SHORT EXPENSIBLE BEARING SUPPORTS > 2008      |
| 12 | 12034401 | KIT 3 HUB CAPS AERO 10 SLOTS BLACK            |

DELIVERED WITH

|   |  |
|---|--|
| BR101 quick releases<br>(M40350 frt, M40351 rear road, M40352 rear MTB) |  |
| BR101 quick releases<br>(M40350 frt, M40351 rear road, M40352 rear MTB) |  |
| BR101 quick releases<br>(M40350 frt, M40351 rear road, M40352 rear MTB) |  |
| BR101 quick releases<br>(M40350 frt, M40351 rear road, M40352 rear MTB) |  |
| BR101 quick releases<br>(M40350 frt, M40351 rear road, M40352 rear MTB) |  |
| Rim tape  |  |
| Rim tape  |  |
| Rim tape  |  |
| Rim tape  |  |
| Rim tape  |  |
| User guide  |  |
| User guide  |  |
| User guide  |  |
| User guide  |  |
| User guide  |  |

COMPATIBILITY

|  |  |
|--|--|
| Freewheel: Shimano/Sram, convertible to Campagnolo with optional driver body                           |  |
| Freewheel: Shimano/Sram, convertible to Campagnolo with optional driver body                           |  |
| Freewheel: Shimano/Sram, convertible to Campagnolo with optional driver body                           |  |
| Freewheel: Shimano/Sram, convertible to Campagnolo with optional driver body                           |  |
| Front axle: Quick Release only   |  |
| Freewheel body: convertible CAMPAGNOLO ED11 (kit 30871201 sold separately)                             |  |
| Front axle: Quick Release only   |  |
| Front axle: Quick Release only   |  |
| Front axle: Quick Release only   |  |
| Rear axle: Quick Release only  |  |
| Rear axle: Quick Release only  |  |
| Rear axle: Quick Release only  |  |
| FTS-L Shimano / Sram freewheel body (30871101 - Delivered on the wheel)                                |  |
| Front axle: Quick Release only   |  |
| Rear axle: 12mm thru axle, convertible to Quick Release with adapters (delivered with non-boost wheel) |  |

Specifications

RIMS

- **Material** : S6000 Aluminum
- **Material** : S6000 Aluminum
- **Material** : S6000 Aluminum
- **Material** : S6000 Aluminum
- **Material** : S6000 Aluminum

WHEEL HUB

- **Body** : aluminum
- **Front and rear bodies** : aluminum
- **Axle material** : steel
- **Freewheel** : FTS-L steel

WHEEL WEIGHTS

995