

**ASTM CATEGORY 1 : road only**

Maximum tyre pressure: 2.55bar/37PSI with a 54mm tyre - 1.3bar/19PSI with a 125mm tyre

For a longer longevity of the wheel, Mavic recommends that the total weight supported by the wheels don't exceed 120kg, bike included

Maximum tyre pressure: 7.5bar/108PSI with a 23mm tyre - 4.6bar/67PSI with a 52mm tyre

Recommended tyre sizes: 25 to 32 mm

Max. Pressure: see indication on wheel and tyre. If they differ, use the lower of the 2

Max. Pressure: 23mm 8.7 bars - 125 psi, 25/28mm 7.7 bars - 110 psi

Maximum tyre size: width 52mm - pressure max. 5Bar/72PSI

**REFERENCES WHEELS**

R23241 AKSIUM RB 700 QR M11

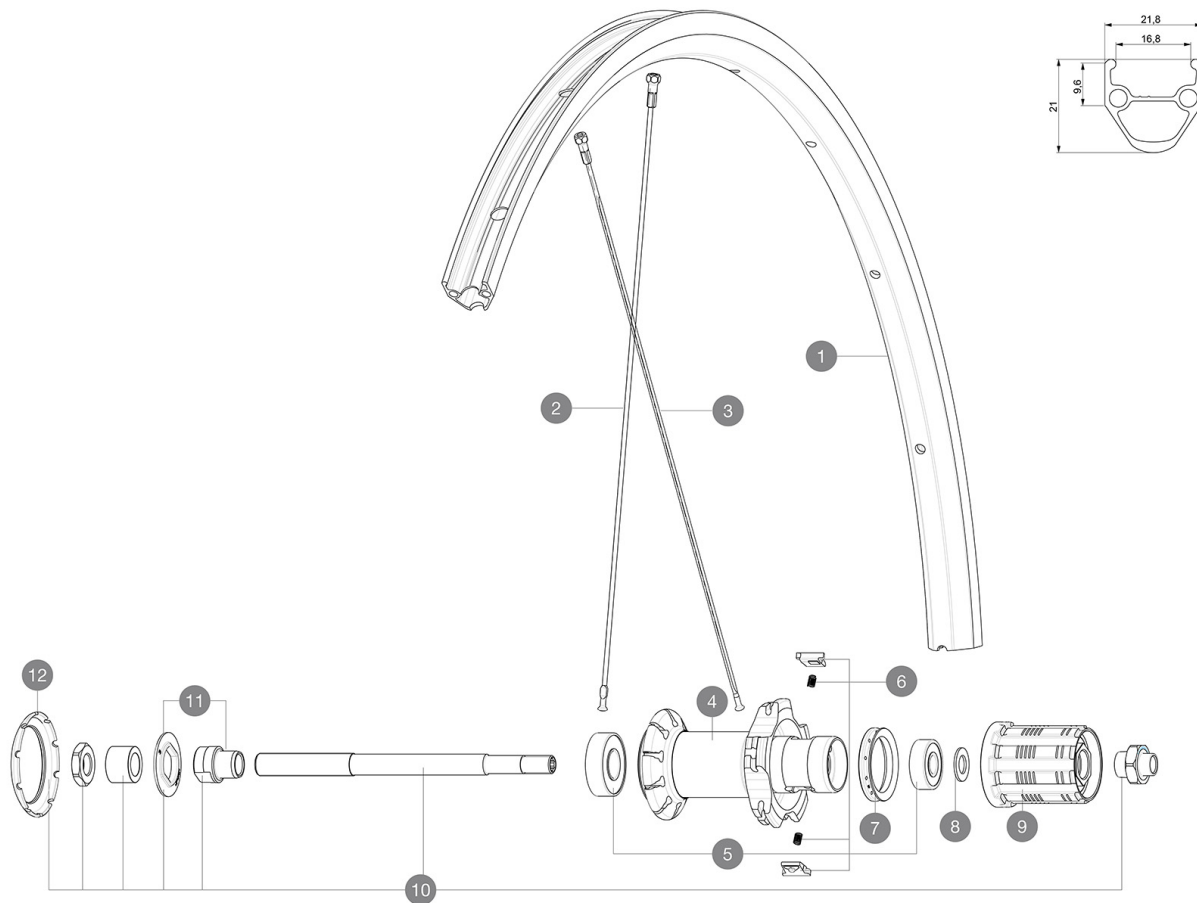

**RIMS**



&NBSP::

1 jantearrouteub REAR ROAD UB RIM

**SPOKES**

2 V2272701 KIT 10 FT/NDS AKSIUM RND SPK 283mm (OEM only)  
3 V3661501 KIT 10 DS AKSIUM 19 FLAT SPOKE 301mm + nipples

**HUB SHELLS**

5 M40660 REAR HUB 608+6001 BEARINGS  
6 M40578 FTSL PAWLS KIT (ROAD WHEELS)  
7 99500001 FTSL/FTSX FREEHUB BODY SEAL  
8 M40067 INTERNAL FREEWHEEL SPACER FTSL/FTSX  
9 30871101 FTS-L ROAD FREEWHEEL BODY HG11 8/9 compatible  
10 99603901 REAR AXLE QRM ROAD 2008  
11 99603801 SHORT EXPENSIBLE BEARING SUPPORTS > 2008  
12 12034401 KIT 3 HUB CAPS AERO 10 SLOTS BLACK

**DELIVERED WITH**

BR101 quick releases (M40350 frt, M40351 rear road, M40352 rear MTB)	
BR101 quick releases (M40350 frt, M40351 rear road, M40352 rear MTB)	
BR101 quick releases (M40350 frt, M40351 rear road, M40352 rear MTB)	
BR101 quick releases (M40350 frt, M40351 rear road, M40352 rear MTB)	
BR101 quick releases (M40350 frt, M40351 rear road, M40352 rear MTB)	
Rim tape	
Rim tape	
Rim tape	
Rim tape	
Rim tape	
Rim tape	
User guide	
User guide	
User guide	
User guide	
User guide	

**COMPATIBILITY**

Freewheel: Shimano/Sram, convertible to Campagnolo with optional driver body	
Freewheel: Shimano/Sram, convertible to Campagnolo with optional driver body	
Freewheel: Shimano/Sram, convertible to Campagnolo with optional driver body	
Freewheel: Shimano/Sram, convertible to Campagnolo with optional driver body	
Front axle: Quick Release only	
Front axle: Quick Release only	
Freewheel body: convertible CAMPAGNOLO ED11 (kit 30871201 sold separately)	
Front axle: Quick Release only	
Front axle: Quick Release only	
Rear axle: Quick Release only	
Rear axle: Quick Release only	
Rear axle: Quick Release only	
Rear axle: Quick Release only	
Front axle: Quick Release only	
Rear axle: 12mm thru axle, convertible to Quick Release with adapters (delivered with non-boost wheel)	
FTS-L Shimano / Sram freewheel body (30871101 - Delivered on the wheel)	

**Specifications****RIMS**

- **Material** : S6000 Aluminum
- **Material** : S6000 Aluminum
- **Material** : S6000 Aluminum
- **Material** : S6000 Aluminum
- **Material** : S6000 Aluminum

**WHEEL HUB**

- **Body** : aluminum
- **Front and rear bodies** : aluminum
- **Axle material** : steel
- **FTS-L**
- **Freewheel** : FTS-L steel

**WHEEL WEIGHTS**

995