

ASTM CATEGORY 1 : road only
 Maximum tyre pressure: 2.55bar/37PSI with a 54mm tyre - 1.3bar/19PSI with a 125mm tyre
 For a longer longevity of the wheel, Mavic recommends that the total weight supported by the wheels don't exceed 120kg, bike included
 Maximum tyre pressure: 7.5bar/108PSI with a 23mm tyre - 4.6bar/67PSI with a 52mm tyre
 Recommended tyre sizes: 25 to 32 mm
 Max. Pressure: see indication on wheel and tyre. If they differ, use the lower of the 2
 Max. Pressure: 23mm 8.7 bars - 125 psi, 25/28mm 7.7 bars - 110 psi
 Maximum tyre size: width 52mm - pressure max. 5Bar/72PSI

REFERENCES WHEELS

R23241AKSIUM RB 700 QR M11

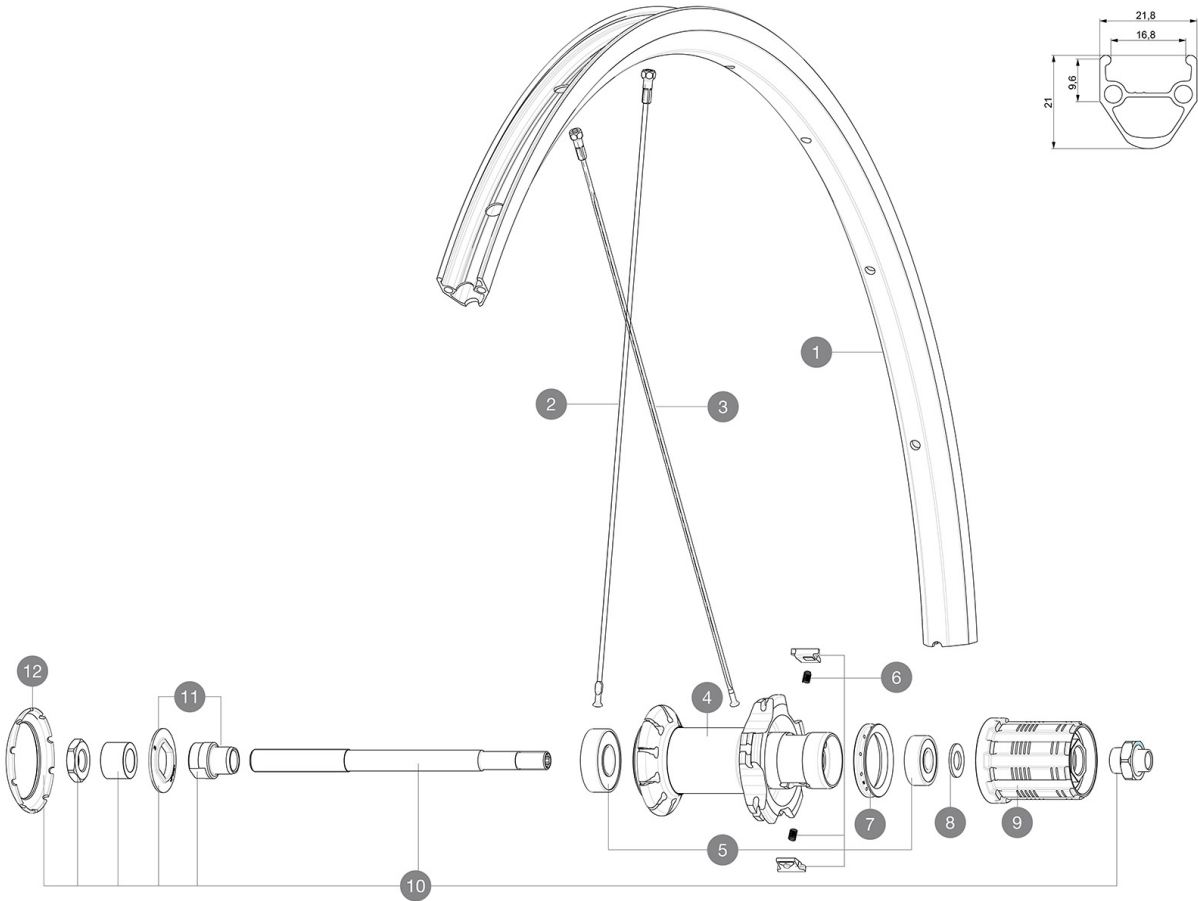

RIMS



1jantearrouteubREAR ROAD UB RIM

SPOKES

2V2272701KIT 10 FT/NDS AKSIUM RND SPK 283mm (OEM only)

3V3661501KIT 10 DS AKSIUM 19 FLAT SPOKE 301mm + nipples

HUB SHELLS

5M40660REAR HUB 608+6001 BEARINGS

6M40578FTSL PAWLS KIT (ROAD WHEELS)

799500001FTSL/FTSX FREEHUB BODY SEAL

8M40067INTERNAL FREEWHEEL SPACER FTSL/FTSX

930871101FTS-L ROAD FREEWHEEL BODY HG11 8/9 compatible

1099603901REAR AXLE QRM ROAD 2008

1199603801SHORT EXPENSIBLE BEARING SUPPORTS > 2008

1212034401KIT 3 HUB CAPS AERO 10 SLOTS BLACK

DELIVERED WITH

| | |
|---|--|
| BR101 quick releases (M40350 frt, M40351 rear road, M40352 rear MTB) | |
| BR101 quick releases (M40350 frt, M40351 rear road, M40352 rear MTB) | |
| BR101 quick releases (M40350 frt, M40351 rear road, M40352 rear MTB) | |
| BR101 quick releases (M40350 frt, M40351 rear road, M40352 rear MTB) | |
| BR101 quick releases (M40350 frt, M40351 rear road, M40352 rear MTB) | |
| Rim tape | |
| Rim tape | |
| Rim tape | |
| Rim tape | |
| Rim tape | |
| Rim tape | |
| User guide | |
| User guide | |
| User guide | |
| User guide | |
| User guide | |
| User guide | |

COMPATIBILITY

| | |
|--|--|
| Freewheel: Shimano/Sram, convertible to Campagnolo with optional driver body | |
| Freewheel: Shimano/Sram, convertible to Campagnolo with optional driver body | |
| Freewheel: Shimano/Sram, convertible to Campagnolo with optional driver body | |
| Freewheel: Shimano/Sram, convertible to Campagnolo with optional driver body | |
| Front axle: Quick Release only | |
| Front axle: Quick Release only | |
| Front axle: Quick Release only | |
| Freewheel body: convertible CAMPAGNOLO ED11 (kit 30871201 sold separately) | |
| Front axle: Quick Release only | |
| Rear axle: Quick Release only | |
| Rear axle: Quick Release only | |
| Rear axle: Quick Release only | |
| Rear axle: Quick Release only | |
| Front axle: Quick Release only | |
| Rear axle: 12mm thru axle, convertible to Quick Release with adapters (delivered with non-boost wheel) | |
| FTS-L Shimano / Sram freewheel body (30871101 - Delivered on the wheel) | |

Specifications

RIMS

- **Material** : S6000 Aluminum
- **Material** : S6000 Aluminum
- **Material** : S6000 Aluminum
- **Material** : S6000 Aluminum
- **Material** : S6000 Aluminum

WHEEL HUB

- **Body** : aluminum
- **Front and rear bodies** : aluminum
- **Axle material** : steel
- **FTS-L**
- **Freewheel** : FTS-L steel

WHEEL WEIGHTS

995