

ASTM A 2106 2 : 15 120 28 62 mm (1.1" 2.5")
 Maximum tyre pressure: 5.5bar/80PSI with a 28mm tyre - 3.25bar/47PSI with a 64mm tyre
 30mm 5.8 bars - 85 PSI / 35mm 5.1 bars - 74 PSI / 40mm 4.5 bars - 65 PSI

参照ホイール

F81241	ALLROAD INT 700 12X100	F81261	ALLROAD CL 700 12X100
--------	------------------------	--------	-----------------------

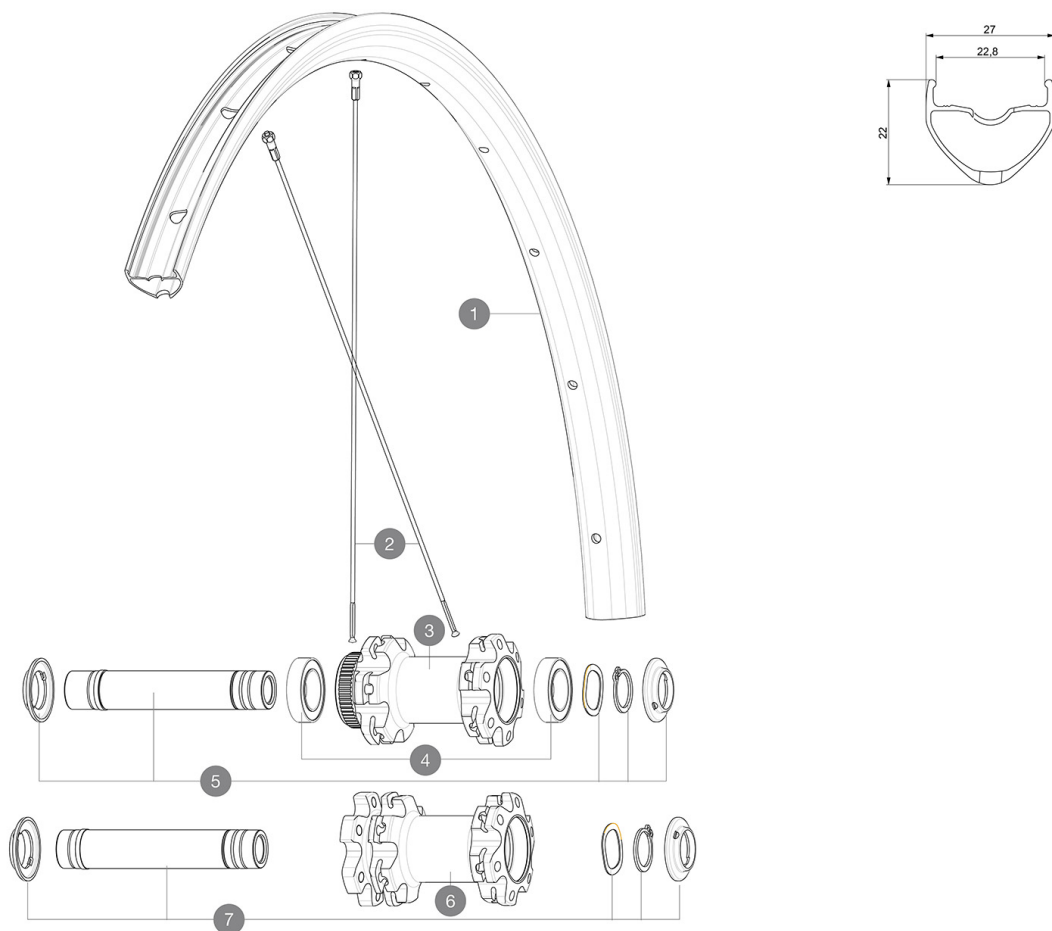

RIMS



&NBSP;:

1	V2734915	KIT FRONT/REAR RIM ALLROAD UST Disc
	V2700101	UST Tape 28mm for 25 to 27mm wide rims

SPOKES

2	V3664601	KIT 12 FRT/NDS ALLROAD UST Disc ROUND SPOKE 296mm + nipple
---	----------	--

HUB SHELLS

3	N/A	HUB BODY
4	V2500901	KIT BEARINGS 18x30x7 + WAVED WASHER + CLIP
5	V2374001	KIT 12x100mm FRONT AXLE DCL QRM AUTO ALLROAD > 2019
7	V2374501	KIT 12mm FRT AXLE D6T QRM Auto Allroad 19

OPTIONS

V2373501	QRM Auto front axle 15mm for DCL Allroad wheels > 2019
V2372301	KIT 100mm AXLE QRM AUTO MTB > 2019

ADAPTERS

V2372501	15mm MTB Axle Cap QRM Auto From 2019
V2680301	"Kit Ft Road Adapter 12 >> 9mm"

付属品

01 01 01 01 QR QR QR QR (MTBA 996 941) 01 01 01 01 B41 043 01)	
01 01 01 01 QR QR QR QR (MTBA 996 941) 01 01 01 01 B41 043 01)	
01 01 01 01 QR QR QR QR (MTBA 996 941) 01 01 01 01 B41 043 01)	
01 01 01 01 QR QR QR QR (MTBA 996 941) 01 01 01 01 B41 043 01)	
01 01 01 01 QR QR QR QR (MTBA 996 941) 01 01 01 01 B41 043 01)	
01 01 01 01 QR QR QR QR (MTBA 996 941) 01 01 01 01 B41 043 01)	
360 360 360 360 QR QR QR QR (B49 894 01)	
360 360 360 360 QR QR QR QR (B49 894 01)	
360 360 360 360 QR QR QR QR (B49 894 01)	
360 360 360 360 QR QR QR QR (B49 894 01)	
360 360 360 360 QR QR QR QR (B49 894 01)	
360 360 360 360 QR QR QR QR (B49 894 01)	
360 360 360 360 QR QR QR QR (B49 894 01)	
UST UST UST UST (129 838 01)	
UST UST UST UST (129 838 01)	
UST UST UST UST (129 838 01)	
UST UST UST UST (129 838 01)	
UST UST UST UST (129 838 01)	

COMPATIBILITY

01 01 01 01 QR QR QR QR (MTBA 996 941) 01 01 01 01 B41 043 01)
01 01 01 01 QR QR QR QR (MTBA 996 941) 01 01 01 01 B41 043 01)
01 01 01 01 QR QR QR QR (MTBA 996 941) 01 01 01 01 B41 043 01)
01 01 01 01 QR QR QR QR (MTBA 996 941) 01 01 01 01 B41 043 01)
01 01 01 01 QR QR QR QR (MTBA 996 941) 01 01 01 01 B41 043 01)
01 01 01 01 QR QR QR QR (MTBA 996 941) 01 01 01 01 B41 043 01)
360 360 360 360 QR QR QR QR (B49 894 01)
360 360 360 360 QR QR QR QR (B49 894 01)
360 360 360 360 QR QR QR QR (B49 894 01)
360 360 360 360 QR QR QR QR (B49 894 01)
360 360 360 360 QR QR QR QR (B49 894 01)
360 360 360 360 QR QR QR QR (B49 894 01)
360 360 360 360 QR QR QR QR (B49 894 01)
360 360 360 360 QR QR QR QR (B49 894 01)
UST UST UST UST (129 838 01)
UST UST UST UST (129 838 01)
UST UST UST UST (129 838 01)
UST UST UST UST (129 838 01)
UST UST UST UST (129 838 01)