

ASTM CATEGORY 1 : road only

For a longer longevity of the wheel, Mavic recommends that the total weight supported by the wheels don't exceed 120kg, bike included

Recommended tyre sizes: 25 to 32 mm

Max. Pressure: see indication on wheel and tyre. If they differ, use the lower of the 2

## REFERENCES WHEELS

R22861 Cos Pro Carb DCL 650b Rr

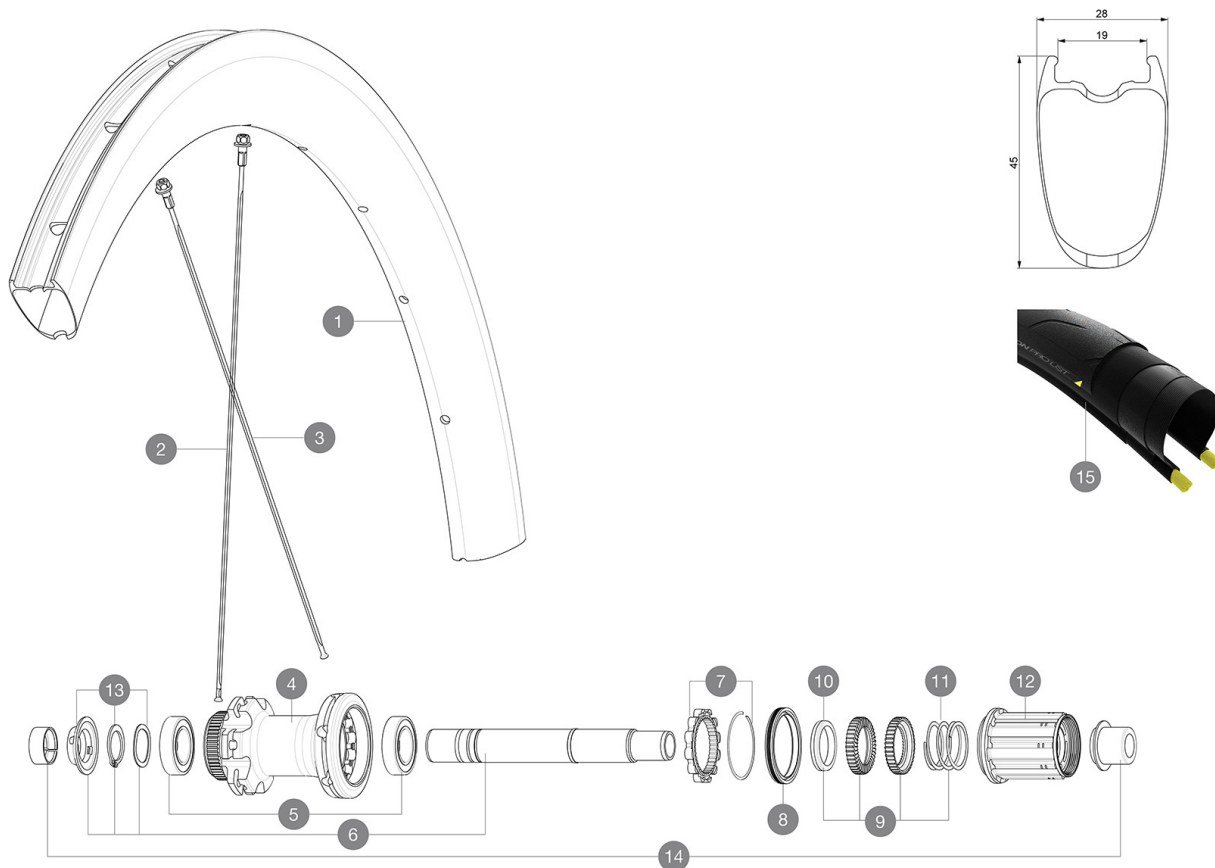

## RIMS



&NBSP;:

|   |          |  |
|---|----------|--|
| 1 | V2738013 | KIT REAR RIM COSMIC PRO CARBON UST Disc 650B |
|   | V2620101 | UST RIM TAPE 25mm (for 21-24mm wide rim)     |

## SPOKES

|   |          |  |
|---|----------|--|
| 2 | V3666701 | KIT 2 FRT/NDS STAMPED SPOKE 255 COSMIC PRO CARBON UST Disc 6 |
| 2 | V3666901 | KIT 12 NDS COSMIC PRO CARBON UST Disc 650B SPOKE 255mm + nip |
| 3 | V3666801 | KIT 12 DS COSMIC PRO CARBON UST Disc 650B SPOKE 251mm + nip  |

## HUB SHELLS

|    |          |   |
|----|----------|---|
| 4  | N/A      | HUB BODY  |
| 5  | M40076   | HUB BEARINGS 17x30x7 6903 x 2                         |
| 6  | V2373401 | KIT ID360 135/142 DCL L1 AXLE WITH CLIP               |
| 7  | V2252701 | KIT ID360 INSERT SHAPED EAR LOBE > 2017               |
| 8  | V2251601 | KIT ID360 SEAL + GREASE                               |
| 9  | V2251701 | KIT ID360 2 RATCHETS + SPRING + GREASE                |
| 10 | V2500501 | KIT ID360 3 PADS NOISE REDUCING                       |
| 11 | V2251801 | KIT 3 ID360 ROAD SPRINGS                              |
| 12 | V3430101 | HG11 Freewheel Body ID360                             |
| 13 | V2373001 | KIT ADJUST. SYSTEM QRM AUTO ID360 for 17x30x7 bearing |

## TYRES

15 39938825 Yksion Pro UST 700x25

## ADAPTERS

14 V2510701 ID360V2RrAxleAdapt12x142/148  
V2510901 ID360 EVO RrAxleAdpt12x135/150  
V2510801 ID360 V2 RrAxleAdapt9x135



# Cosmic Pro Carbon UST Disc 650

2019  
REAR

## DELIVERED WITH

|  |   |
|--|---|
| Mavic tyre sealant (rear wheel)<br>(355 466 01)                  |   |
| Tyre sealant syringe   |   |
| Front QR adapters<br>(996 941 01 for MTB or B41 043 01 for road) |   |
| Front QR adapters<br>(996 941 01 for MTB or B41 043 01 for road) |   |
| Rear QR adapters for Instant Drive 360<br>(B49 894 01)           |   |
| Rear QR adapters for Instant Drive 360<br>(B49 894 01)           |   |
| UST valve and accessories<br>(129 838 01)                        |  |
| Tubeless rim tape  |   |
| User guide   |   |

## COMPATIBILITY

|   |  |
|---|--|
| Freewheel: Shimano/Sram, convertible to Campagnolo and XD-R with optional driver bodies   |  |
| Front axle: 12x100 thru axle, easily convertible to quick release with included adapters. Not compatible with 15mm through axles. |  |
| Front axle: 12x100 thru axle, easily convertible to quick release with included adapters. Not compatible with 15mm through axles. |  |
| Rear axle: 12mm thru axle, convertible to Quick Release with included adapters  |  |
| Rear axle: 12mm thru axle, convertible to Quick Release with included adapters  |  |

## Specifications

### RIMS

- **Material** : 3K carbon fibers
  - **Height** : 45 mm
  - **Drilling** : traditional
- Disc brake specific profile
- **Valve hole diameter** : 6.5 mm
  - **Tyre** : UST Tubeless and tubetype
  - **Internal width** : 19 mm
  - **ETRTO size** : 584x19TC Road
- Use with Mavic Tubeless Tape  
Use with Mavic Tubeless Tape

### SPOKES

- **Material** : steel
- **Shape** : straight pull, flat, double butted
- **Nipples** : steel, ABS
- **Count** : 24 front and rear
- **Lacing** : front and rear crossed 2

### WHEEL HUB

- **Front and rear bodies** : aluminum
  - **Axle material** : aluminum
- Auto adjust sealed cartridge bearings (QR Auto), front and rear
- **Freewheel** : Instant Drive 360
  - **Front** : Quick release and 12x100 through axle compatible
  - **Rear** : Quick Release, 12x142 and 12x135 compatible
  - **Rear** : Quick Release, 12x142 and 12x135 compatible

### VERSIONS

- **Color** : Black only
- **Disc standard** : Center Lock(R) only
- **Disc standard** : Center Lock(R) only

### WHEEL WEIGHTS

860