

ASTM A270 4 : 4
120
46mm 64mm (1.8" 2.5")

参照ホイール

F83721 Deemax Pro 27,5 19 Ft Boost F83711 Deemax Pro 27,5 19 Ft

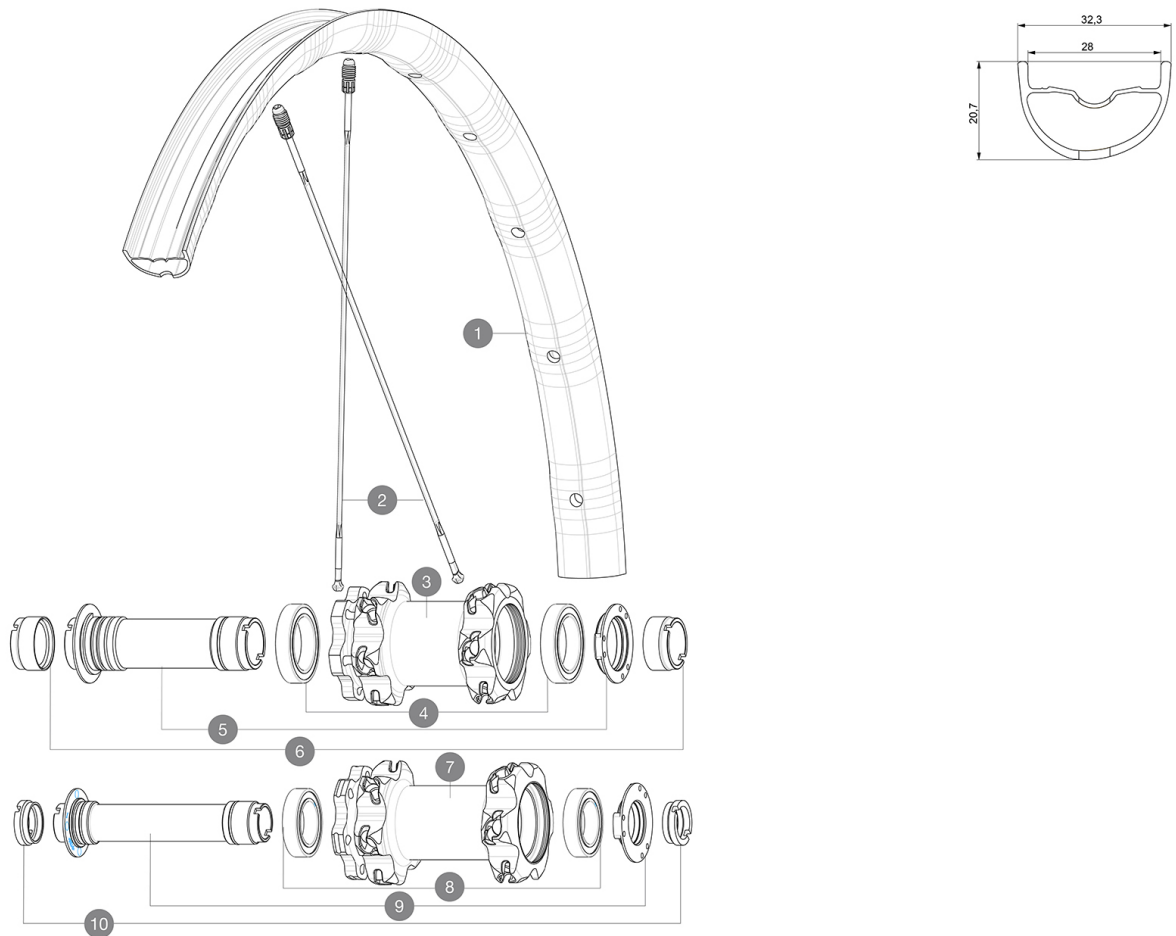

RIMS



&NBSP;:

1	V3760210	KIT FRONT RIM DEEMAX PRO 19 27,5"
---	----------	-----------------------------------

SPOKES

2	V2386101	KIT 1 FRT/1 NDS STAMPED SPOKES 275mm DEEMAX PRO - while
2	V2384701	KIT 12 FRONT + 1 REAR NON-DRIVE SIDE BUTTED ZICRAL SPOKES 2

HUB SHELLS

3	N/A	HUB BODY
4	M40179	FRONT BEARING 25x37x7 20mm AXLE
5	30870501	FRONT AXLE 20mm CROSSMAX ST/SX + DEEMAX ULTI 2012
7	N/A	HUB BODY
8	99688501	BEARING KIT 9/15 D6T HUB
9	V2370701	KIT FRONT QRM+ AXLE BOOST INTL 110mm

OPTIONS

V2650201	ADAPTER Front Torque Cap 15x31 MTB QRM +
----------	--

ADAPTERS

6	12982901	20mm adapter for Crossmax ST/SX (front wheel)
10	B4104401	15mm FT Road Axle Adapters 16
	B4104301	9mm FT road Axle Adapters 16
	12982801	15mm ADAPTER KIT - 2012 WHEELS
	12982701	9mm Adapters + QR for Crossmax ST/SX (front wheel)

MAVIC Deemax Pro 27,5

付属品

UST (129 838 01)	

COMPATIBILITY

Front axle: 20mm, convertible to 15mm thru axle with included adapters	

Specifications

リム

- RIM : FORE
- RIM : ISM 4D
- RIM : 6.5mm
- RIM : UST
- RIM : 28mm
- RIM : 360

スポーク

- RIM : FORE
- RIM : ISM 4D
- RIM : 6.5mm
- RIM : UST
- RIM : 28mm
- RIM : 360

ホイールハブ

- HUB : FORE
- HUB : ISM 4D
- HUB : 6.5mm
- HUB : UST
- HUB : 28mm
- HUB : 360

VERSIONS

- VERSION : 6
- VERSION : 110mm
- VERSION : 148mm
- VERSION : XD

ホイールの重み

- Weight Front 27.5": 840
- Weight Front 29": 890