

# MAVIC Ksyrium Elite UST Disc

ASTM CATEGORY 2 : road and offroad with jumps less than 15cm

For a longer longevity of the wheel, Mavic recommends that the total weight supported by the wheels don't exceed 120kg, bike included

Recommended tyre sizes: 25 to 32 mm

Max. Pressure: see indication on wheel and tyre. If they differ, use the lower of the 2

## REFERENCES WHEELS

R33681 Ksyrium El UST DCL 20 Rr

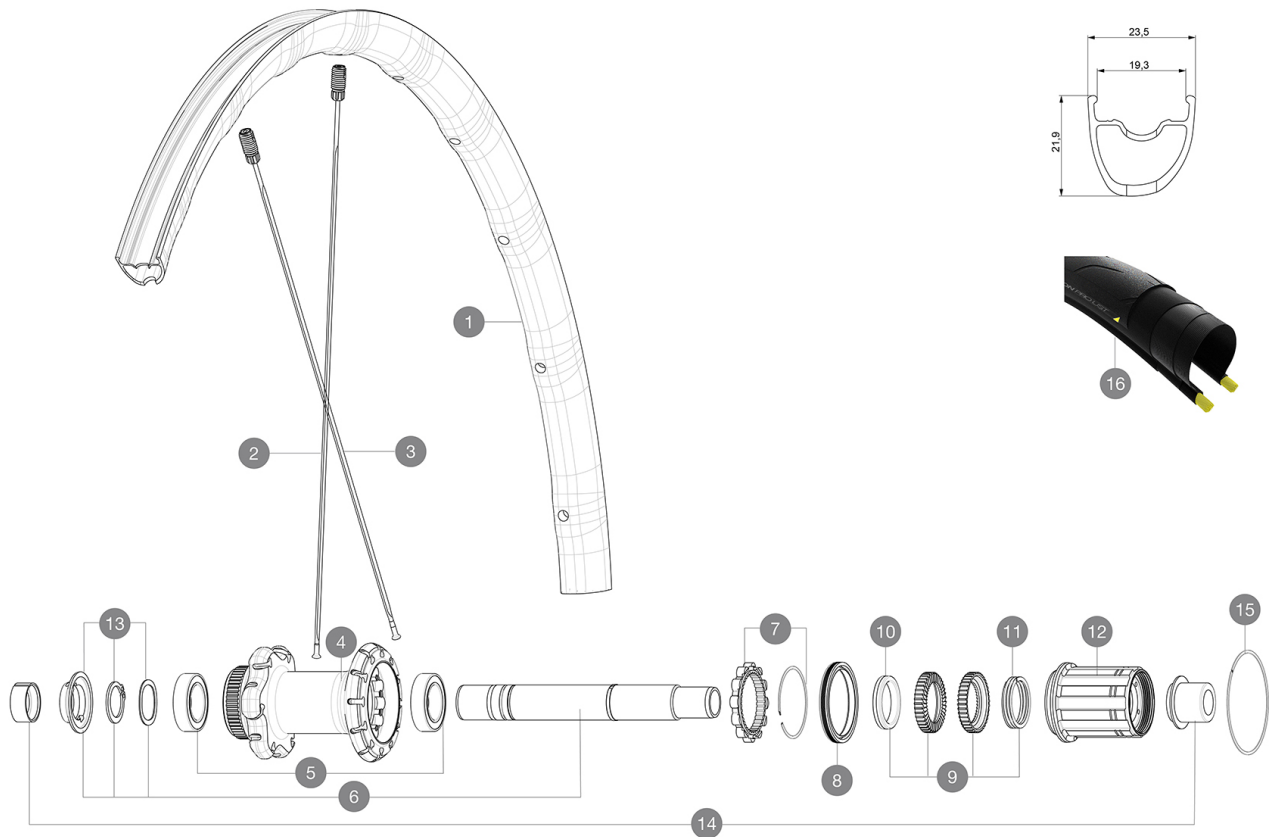

## RIMS



&NBSP;:

1 V2739813 KIT REAR RIM KSYRIUM ELITE DISC UST 20

## SPOKES

2 V2273401 KIT 12 FRT/NON DRIVE SIDE BUTTED SPOKE 297mm  
3 V2273501 KIT 12 DRIVE SIDE BUTTED SPOKE 280mm

## HUB SHELLS

4 N/A HUB BODY  
5 V2560401 KIT 2 BEARINGS 17x28x7 + WAVED WASHER + CLIP  
6 V2252901 KIT ID360 CENTER LOCK 135/142mm AXLE W/CLIP  
7 V2252701 KIT ID360 INSERT SHAPED EAR LOBE > 2017  
8 V2251601 KIT ID360 SEAL + GREASE  
9 V2251701 KIT ID360 2 RATCHETS + SPRING + GREASE  
10 V2500501 KIT ID360 3 PADS NOISE REDUCING  
11 V2251801 KIT 3 ID360 ROAD SPRINGS  
12 V3430101 HG11 Freewheel Body ID360  
13 V2560501 KIT ADJUST. SYSTEM QRM AUTO ID360 for 17x28x7 bearing  
15 V2252201 KIT 2 REAR HUB RETENTION RINGS 48mm

## TYRES

16 39938825 Yksion Pro UST 700x25

## ADAPTERS

14 V2510701 ID360V2RrAxleAdapt12x142/148  
V2510801 ID360 V2 RrAxleAdapt9x135  
V2510901 ID360 EVO RrAxleAdpt12x135/150

# MAVIC Ksyrium Elite UST Disc

## DELIVERED WITH

Mavic tyre sealant (rear wheel) (355 466 01)	
Tyre sealant syringe	
Front QR adapters (996 941 01 for MTB or B41 043 01 for road)	
Rear QR adapters for Instant Drive 360 (B49 894 01)	
UST valve and accessories (129 838 01)	
User guide	

## COMPATIBILITY

Freewheel: Shimano/Sram, convertible to Campagnolo and XD-R with optional driver bodies	
Front axle: 12mm thru axle, easily convertible to quick release with included adapters. Convertible to 15mm with complete axle replacement	
Rear axle: 12mm thru axle, convertible to Quick Release with included adapters	

## Specifications

### RIMS

- **Material** : Mactal
  - **Height** : 22 mm
  - **Joint** : SUP
  - **Drilling** : Fore
- Disc brake specific profile
- **Weight reduction** : ISM 4D
  - **Valve hole diameter** : 6.5 mm
  - **Tyre** : UST Tubeless and tubetype
  - **Internal width** : 19 mm
  - **ETRTO size** : 622x19TC Road

### SPOKES

- **Material** : steel
- **Shape** : straight pull, flat
- **Nipples** : Fore integrated aluminum
- **Count** : 24 front and rear
- **Lacing** : front crossed 2, rear Isopulse

### WHEEL HUB

- **Front and rear bodies** : aluminum
  - **Axle material** : aluminum
- Auto adjust sealed cartridge bearings (QRM Auto), front and rear
- **Freewheel** : Instant Drive 360
  - **Front** : Quick release, 12x100 and 15x100 through axle compatible
  - **Rear** : Quick Release, 12x142 and 12x135 compatible

### VERSIONS

- **Color** : Black only
- **Disc standard** : Center Lock(R) only

### WHEEL WEIGHTS

900