

ASTM CATEGORY 1 : road only  
For a longer longevity of the wheel, Mavic recommends that the total weight supported by the wheels doesn't exceed 120kg, bike included  
Recommended tyre sizes: 23 to 32 mm  
Max. Pressure: see indication on wheel and tyre. If they differ, use the lowest of the 2

## REFERENCES WHEELS

R36741 COS ULT T CL 700 12X142 M11

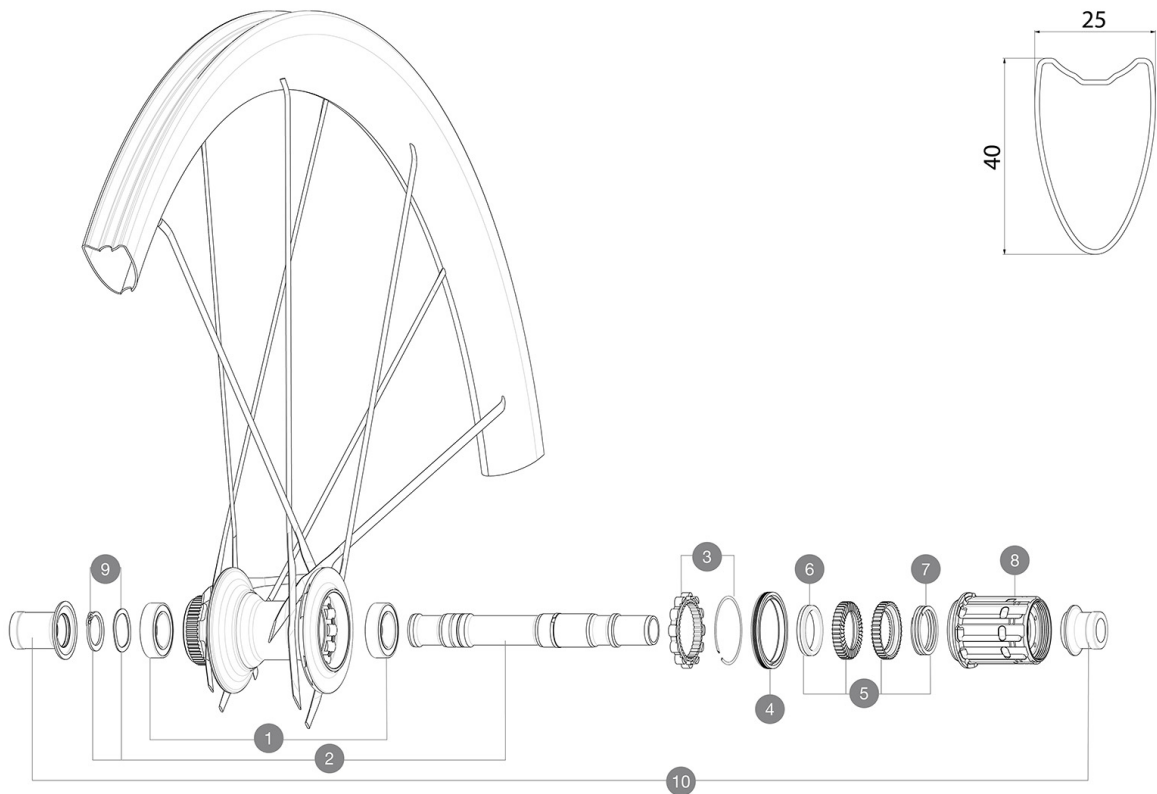

## HUB SHELLS

1	V2560401	KIT 2 BEARINGS 17x28x7 + WAVED WASHER + CLIP
2	V00046431	KIT AXE ID360 142LIGHT CL+CIR
3	V2252701	KIT ID360 INSERT SHAPED EAR LOBE > 2017
4	V00063631	Kit ID360 seal version 2 (larger)
5	V2251701	KIT ID360 2 RATCHETS + SPRING + GREASE
6	V2500501	KIT ID360 3 PADS NOISE REDUCING
7	V2251801	KIT 3 ID360 ROAD SPRINGS
8	V3850101	HG11 Road Freewheel Body Light ID360
9	V2560501	KIT ADJUST. SYSTEM QRM AUTO ID360 for 17x28x7 bearing

## OPTIONS

V2373401	KIT ID360 135/142 DCL L1 AXLE WITH CLIP
----------	---

## ADAPTERS

10	V3811001	KIT ROAD ID360 RR CL ENDCAP (12MM)
	V2510901	ID360 EVO RrAxleAdpt12x135/150
	V2510801	ID360 V2 RrAxleAdapt9x135



# COSMIC ULTIMATE T DISC

2021

REAR

## DELIVERED WITH

Computer magnet (105 416 01)	
Computer magnet (105 416 01)	
Computer magnet (105 416 01)	
Front QR adapters (996 941 01 for MTB or B41 043 01 for road)	
Front QR adapters (996 941 01 for MTB or B41 043 01 for road)	
Front QR adapters (996 941 01 for MTB or B41 043 01 for road)	
Rear QR adapters for Instant Drive 360 (B49 894 01)	
Rear QR adapters for Instant Drive 360 (B49 894 01)	
Rear QR adapters for Instant Drive 360 (B49 894 01)	
User guide	
User guide	
User guide	

## COMPATIBILITY

Freewheel: Shimano/Sram, convertible to Campagnolo and XD-R with optional driver bodies	
Freewheel: Shimano/Sram, convertible to Campagnolo and XD-R with optional driver bodies	
Front axle: 12x100 thru axle, easily convertible to quick release with optional adapters. Not compatible with 15mm through axles.	
Front axle: 12x100 thru axle, easily convertible to quick release with included adapters. Not compatible with 15mm through axles.	
Front axle: 12x100 thru axle, easily convertible to quick release with optional adapters. Not compatible with 15mm through axles	
Rear axle: 12mm thru axle, convertible to Quick Release with included adapters	
Freewheel: Shimano/Sram, convertible to Campagnolo and XD-R with optional driver bodies	
Front axle: 12x100 thru axle, easily convertible to quick release with optional adapters. Not compatible with 15mm through axles	
Instant Drive 360 The new Instant Drive 360 freewheel system is super light and fast to engage with only 9°. A large contactless rubber seal provides low friction, while a wide array of end caps makes it super versatile.	
ID360 N3W freewheel body ([V4270101])	
QRM Auto Qualité de Roulements Mavic Auto Our latest innovation. Those cartridge bearings are of course double sealed with C3 internal clearance. Their preload is automatically adjusted to guarantee a perfect spin with no play on the long run.	
ID360 Shimano / Sram Light freewheel body ([LV3850100])	
ID360 Campagnolo freewheel body ([LV3440100])	
ID360 XD-R freewheel body ([LV2580100])	
ID360 Shimano / Sram freewheel body ([LV3430100] - Delivered on the wheel)	

## Specifications

### RIMS

- Material : 3K carbon fibers
- Material : 3K carbon fibers
- Material : 3K carbon fibers

### WHEEL HUB

- Front hub body : Carbon
- Front hub body : Carbon
- Front and rear bodies : Carbon

### WHEEL WEIGHTS