

Maximum tyre pressure: 4.4bar/64PSI with a 28mm tyre - 2.6bar/38PSI with a 64mm tyre  
ASTM CATEGORY 2 : road and offroad with jumps less than 15cm  
Maximum tyre pressure: 6.75bar/97PSI with a 23mm tyre - 3.8bar/55PSI with a 62mm tyre  
For a longer longevity of the wheel, Mavic recommends that the total weight supported by the wheels doesn't exceed 120kg, bike included  
Recommended tyre sizes: 25 to 32 mm  
Max. Pressure: see indication on wheel and tyre. If they differ, use the lowest of the 2  
Maximum tyre size: width 62mm - pressure max. 3.8Bar/55PSI

## REFERENCES WHEELS

F90311 COS SL 65 CL 700 12X100

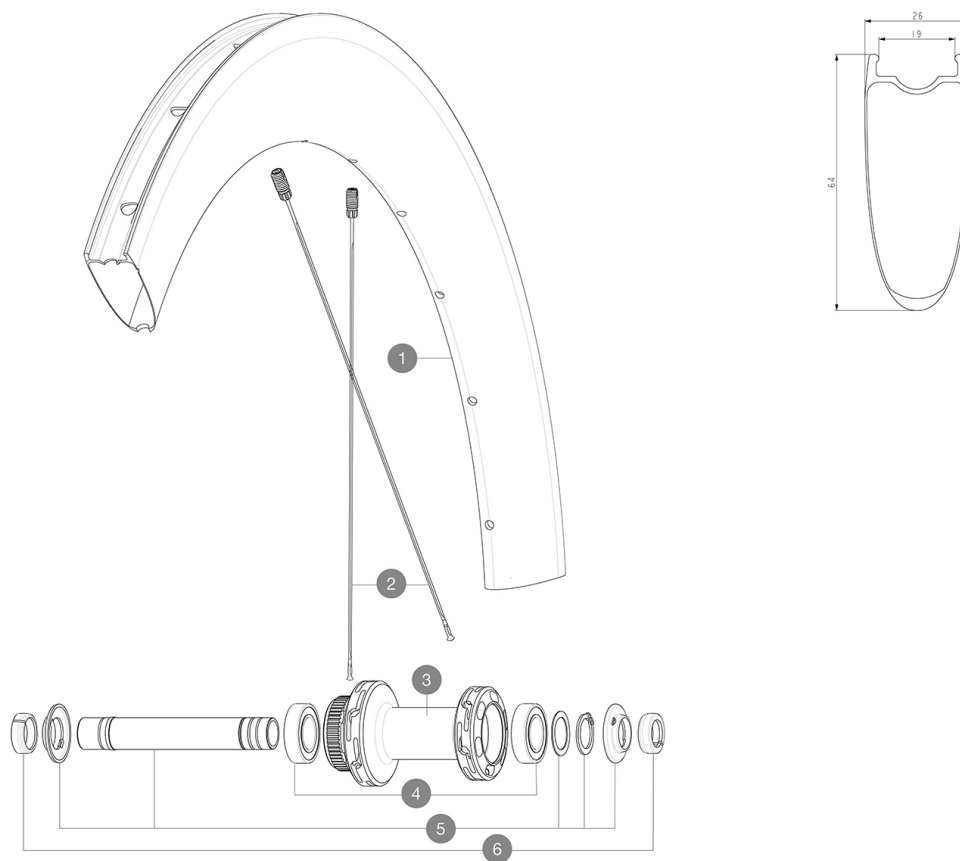

## RIMS



&NBSP;:

|   |          |  |
|---|----------|--|
| 1 | V4093115 | Kit Front/Rear rim Cosmic SL 65 Disc     |
|   | V2620101 | UST RIM TAPE 25mm (for 21-24mm wide rim) |

## SPOKES

|   |          |  |
|---|----------|--|
| 2 | V4163301 | Kit 12 Front/Rear Cosmic SL 65 Disc butted stainless spoke 2 |
|---|----------|--|

## HUB SHELLS

|   |          |                                     |
|---|----------|-------------------------------------|
| 3 | N/A      | HUB BODY                            |
| 4 | M40129   | KIT 2 BEARINGS 6902 15x28x7         |
| 5 | V2373301 | KIT QRM AUTO FRONT AXLE 12mm > 2019 |

## ADAPTERS

|   |          |                                 |
|---|----------|---------------------------------|
| 6 | V2680501 | 12mm Road Axle Cap QRM Auto     |
|   | V2680301 | "Kit Ft Road Adapter 12 >> 9mm" |



# COSMIC SL 65 DISC

2021  
FRONT

## DELIVERED WITH

|  |  |
|--|--|
| Mavic tyre sealant (rear wheel)<br>(355 466 01)                  |  |
| Front QR adapters<br>(996 941 01 for MTB or B41 043 01 for road) |  |
| Front QR adapters<br>(996 941 01 for MTB or B41 043 01 for road) |  |
| Front QR adapters<br>(996 941 01 for MTB or B41 043 01 for road) |  |
| Rear QR adapters for Instant Drive 360<br>(B49 894 01)           |  |
| Rear QR adapters for Instant Drive 360<br>(B49 894 01)           |  |
| Rear QR adapters for Instant Drive 360<br>(B49 894 01)           |  |
| UST valve and accessories<br>(129 838 01)                        |  |
| UST valve and accessories<br>(129 838 01)                        |  |
| UST valve and accessories<br>(129 838 01)                        |  |
| Pre-installed tubeless rim tape                                  |  |
| Pre-installed tubeless rim tape                                  |  |
| User guide   |  |
| User guide   |  |
| User guide   |  |

## COMPATIBILITY

|   |  |
|---|--|
| Freewheel: Shimano/Sram, convertible to Campagnolo and XD-R with optional driver bodies   |  |
| Freewheel: Shimano/Sram, convertible to Campagnolo and XD-R with optional driver bodies   |  |
| Front axle: 12x100 thru axle, easily convertible to quick release with included adapters. Not compatible with 15mm through axles.   |  |
| Front axle: 12x100 thru axle, easily convertible to quick release with included adapters. Not compatible with 15mm through axles.   |  |
| Rear axle: 12mm thru axle, convertible to Quick Release with included adapters  |  |
| Freewheel body: convertible SRAM XD road (kit V2580101 sold separately)   |  |
| Rear axle: 12mm thru axle, convertible to Quick Release with included adapters  |  |
| Freewheel body: convertible SHIMANO HG light road (kit V3850101 sold separately)  |  |
| Freewheel body: convertible SHIMANO MS (kit V3990101 sold separately)   |  |
| Freewheel body: convertible CAMPAGNOLO ED (kit V3440101 sold separately)  |  |
| Front axle: 12x100 thru axle, easily convertible to quick release with included adapters. Not compatible with 15mm through axles.   |  |
| FTS-L Shimano / Sram freewheel body ([30871101] - Delivered on the wheel)   |  |
| Instant Drive 360<br>The new Instant Drive 360 freewheel system is super light and fast to engage with only 9°. A large contactless rubber seal provides low friction, while a wide array of end caps makes it super versatile. |  |
| ID360 Sram XD freewheel body ([V3740101])   |  |
| Rear axle: for fixing nuts only (included), M9x1 thread   |  |
| ID360 Shimano Micro Spline alloy freewheel body ([V3990101])  |  |

## Specifications

### RIMS

Download date: 2024-04-25 / Update date: 2024-02-15

- Material : 100% carbon fiber
- Material : 100% carbon fiber

### WHEEL HUB

Infinity Hub  
Body : aluminium

### WHEEL WEIGHTS

820