

Maximum tyre pressure: 4.4bar/64PSI with a 28mm tyre - 2.6bar/38PSI with a 64mm tyre
ASTM CATEGORY 2 : road and offroad with jumps less than 15cm
For a longer longevity of the wheel, Mavic recommends that the total weight supported by the wheels doesn't exceed 120kg, bike included
Maximum tyre size: width 62mm - pressure max. 3.8Bar/55PSI

REFERENCES WHEELS

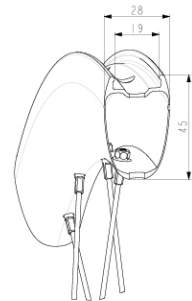

RIMS

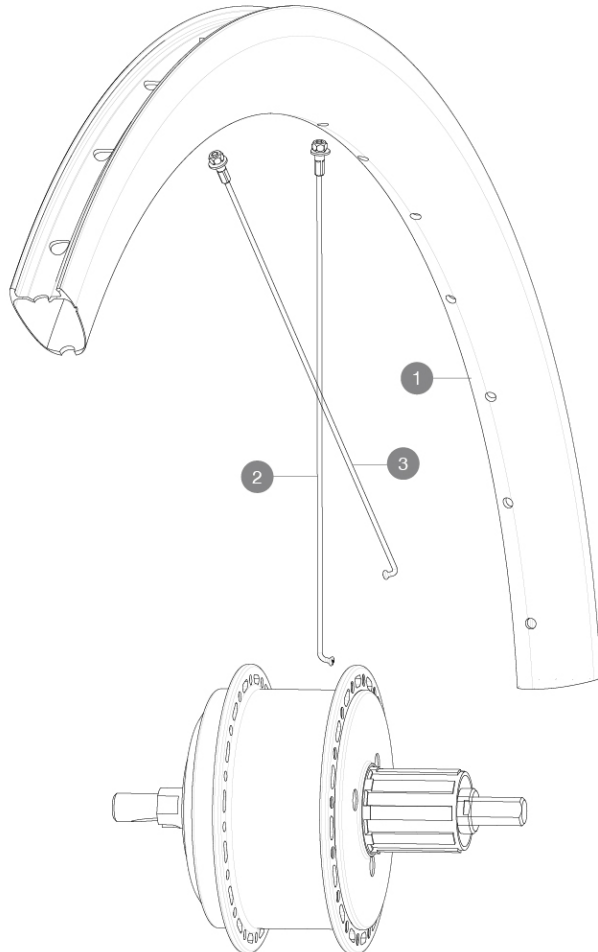

&NBSP;:

1	V4093713	Kit Rear rim Cosmic SL 45 Disc EBM/ CPC UST Disc EBM
	V2620101	UST RIM TAPE 25mm (for 21-24mm wide rim)

SPOKES

2	V3668001	KIT 16 NON DRIVE SIDE J-bent Spoke 230mm COSMIC PRO CARBON U
3	V3667901	KIT 16 DRIVE SIDE J-bent Spoke 228mm COSMIC PRO CARBON UST D



COSMIC SL 45 DISC MAHLE

DELIVERED WITH

Mavic tyre sealant (rear wheel) (355 466 01)	
Front QR adapters	
UST valve and accessories (129 838 01)	
Pre-installed tubeless rim tape	
User guide	

COMPATIBILITY

Instant Drive 360 freewheel technology The new Instant Drive 360 freewheel system is super light and fast to engage with only 9Â°. A large contactless rubber seal provides low friction, while a wide array of end caps makes it super versatile.	
FTS-L Shimano / Sram freewheel body ([30871101] - Delivered on the wheel)	

Specifications

RIMS

- **Material** : 100% carbon fiber
 - **Height** : 45 mm
 - **Drilling** : traditional (front 24 holes and rear 32 holes)
- Disc brake specific profile
- **ETRTO size** : 622x19TC
 - **Tire** : clincher

SPOKES

- **Material** : steel
- **Shape** : straight pull, round
- **Count** : 28 front and rear

WHEEL HUB

- **Body** : aluminum
 - **Disc standard** : 6 Bolts only
 - **Axle material** : aluminum
- Hub available with 6-bolt brake rotors

WHEEL WEIGHTS