

Maximum tyre pressure: 4.4bar/64PSI with a 28mm tyre - 2.6bar/38PSI with a 64mm tyre
ASTM CATEGORY 2 : road and offroad with jumps less than 15cm
For a longer longevity of the wheel, Mavic recommends that the total weight supported by the wheels doesn't exceed 120kg, bike included
Maximum tyre size: width 62mm - pressure max. 3.8Bar/55PSI

REFERENCES WHEELS

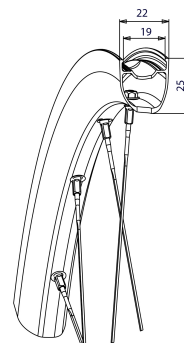

RIMS

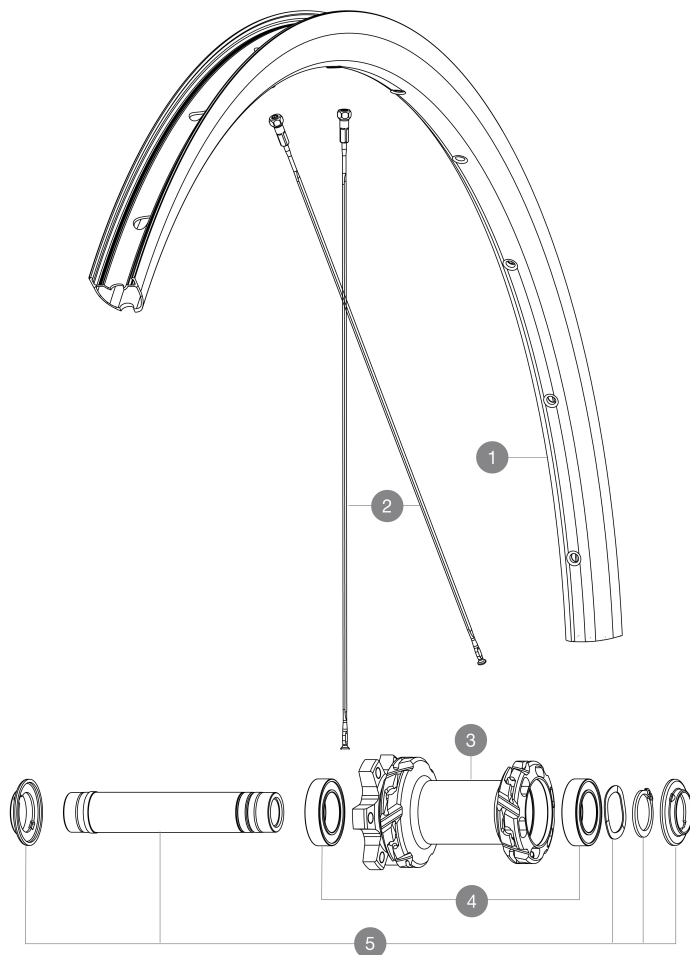

&NBSP;:

1	V4094310	Kit Front rim Ksyrium S Disc EBM
	V2620101	UST RIM TAPE 25mm (for 21-24mm wide rim)

SPOKES

2	V4164401	Kit 12 Front Ksyrium S Disc EBM butted spoke 291mm + steel n
---	----------	--

HUB SHELLS

3	N/A	HUB BODY
4	V2500901	KIT BEARINGS 18x30x7 + WAVED WASHER + CLIP
5	V2375501	Kit QRM auto front axle 100x12/15mm D6T



KSYRIUM S 25 DISC MAHLE

DELIVERED WITH

User guide	
Mavic tyre sealant (rear wheel) (355 466 01)	
Front QR adapters	
UST valve and accessories (129 838 01)	
Pre-installed tubeless rim tape	
Multifunction adjustment wrench (delivered with rear wheel) (325 423 01)	
User guide	
Pre-installed tubeless rim tape	
UST valve and accessories (129 838 01)	
Front QR adapters	
Multifunction adjustment wrench (delivered with rear wheel) (325 423 01)	

COMPATIBILITY

FTS-L Shimano / Sram freewheel body ([30871101] - Delivered on the wheel)	
Instant Drive 360 freewheel technology The new Instant Drive 360 freewheel system is super light and fast to engage with only 9Â°. A large contactless rubber seal provides low friction, while a wide array of end caps makes it super versatile.	

Specifications

RIMS

- **Material** : Mactal
- **Material** : Mactal
- **Height** : 22 mm
- **Height** : 22 mm
- **Joint** : SUP welding technology
- **Joint** : SUP welding technology
- **Drilling** : traditional (front 24 holes and rear 32 holes)
- **Drilling** : traditional (front 24 holes and rear 32 holes)

Disc brake specific profile

Disc brake specific profile

• **ETRTO size** : 622x19TC

• **ETRTO size** : 622x19TC

• **Tire** : clincher

• **Tire** : clincher

SPOKES

• **Material** : steel

• **Material** : steel

• **Shape** : straight pull, round

• **Shape** : straight pull, round

• **Count** : 28 front and rear

• **Count** : 28 front and rear

Instant Drive 360 freewheel technology

WHEEL HUB

• **Body** : aluminum

• **Body** : aluminum

• **Disc standard** : 6 Bolts only

• **Disc standard** : 6 Bolts only

• **Axle material** : aluminum

• **Axle material** : aluminum

Hub available with 6-bolt brake rotors

Hub available with 6-bolt brake rotors

WHEEL WEIGHTS