

MAVIC **CROSSMAX SL R 29**

ASTM CATEGORY 3 : CROSS COUNTRY

For a longer longevity of the wheel, Mavic recommends that the total weight supported by the wheels doesn't exceed 150kg, bike included

Maximum tyre pressure: 4.1bar/59PSI with a 28mm tyre - 2.45bar/36PSI with a 64mm tyre

Recommended tyre sizes: 28 to 64 mm (1.1" to 2.5")

REFERENCES WHEELS

F92991 CROSSMAX SL R INT 29 BST

F93001 CROSSMAX SL R CL 29 BST

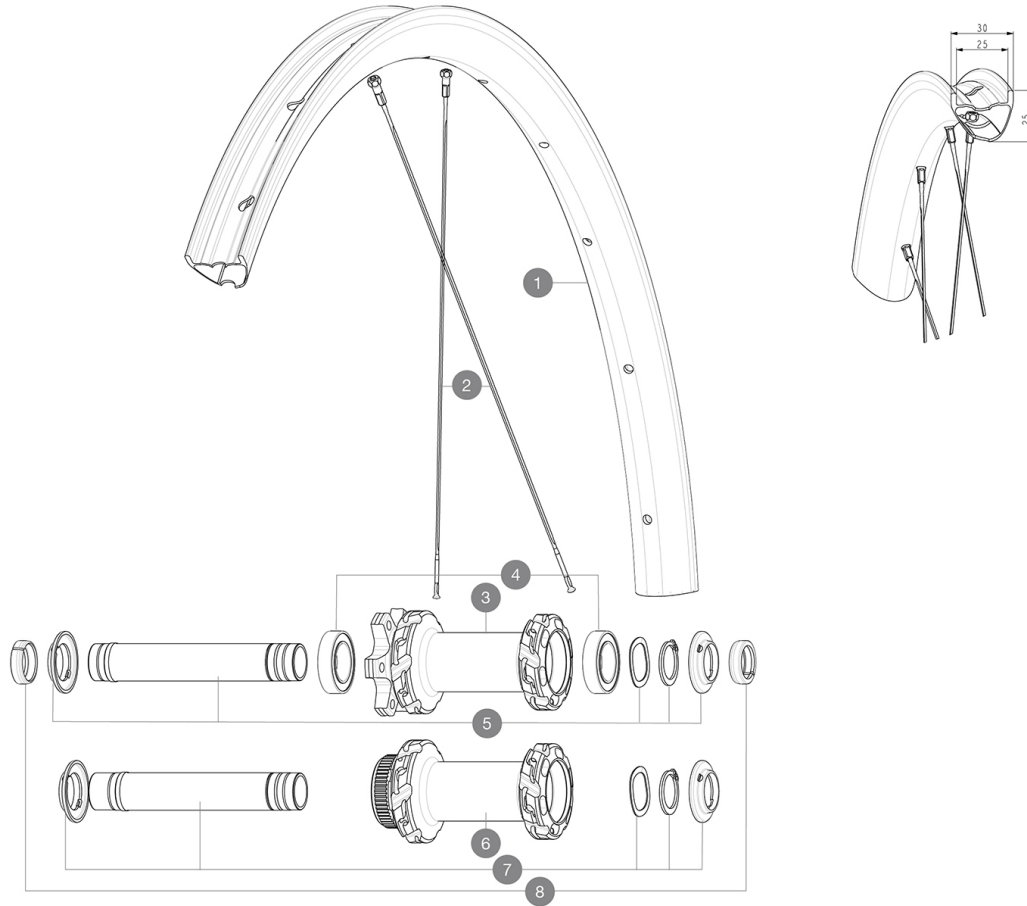
**RIMS**

&NBSP;:

1	V00004731 V2700101	Kit Front/Rear rim Crossmax SLR 29" 22 UST Tape 28mm for 25 to 27mm wide rims
----------	-----------------------	--

SPOKES

2	V2389101	Kit 12Fr/Rr XmaxSL Ultimate spk293+np&w while stock last
2	V00065231	Kit 12 Front/Rear Crossmax SL Ultimate 29" butted stainless

HUB SHELLS

3	N/A	HUB BODY
4	V2500901	KIT BEARINGS 18x30x7 + WAVED WASHER + CLIP
5	V2372401	KIT 110mm AXLE QRM AUTO MTB > 2019
6	N/A	HUB BODY
7	V2375601	Kit 110mm axle QRM auto MTB from 2019 DCL

OPTIONS

V2374401	TORQUE CAPS 15*31 Adapter MTB QRM Auto > 2019 Frt HUB
----------	---

ADAPTERS

8	V2372501 99694101	15mm MTB Axle Cap QRM Auto From 2019 ADAPTER Ft 15 to 9mm QR
----------	----------------------	---

MAVIC **CROSSMAX SL R 29****DELIVERED WITH**

UST valve and accessories (129 838 01)	
UST valve and accessories (129 838 01)	
Pre-installed tubeless rim tape	
Pre-installed tubeless rim tape	
Multifunction adjustment wrench (delivered with rear wheel) (325 423 01)	
User guide	
2 replacement spokes with each wheel	
2 replacement spokes with each wheel	

COMPATIBILITY

Front axle: 15x110 Boost thru axle	
Freewheel body: convertible SHIMANO HG MTB steel (kit V3790101 sold separately)	
Rear axle adapters: 12x148 convertible to 9x141 (kit V2510801 sold separately)	
Rear axle: 12x148 Boost thru axle	
Front axle: 15x110 Boost thru axle	
Boost Axles : 15X110 ; 12X148	
Instant Drive 360 freewheel technology The new Instant Drive 360 freewheel system is super light and fast to engage with only 9Å°. A large contactless rubber seal provides low friction, while a wide array of end caps makes it super versatile.	
Front axle: for fixing nuts only (included), M9x1 thread	

Specifications**RIMS**

- **Material** : 100% carbon fiber with UDÅ² external layer
 - **Material** : 100% carbon fiber with UDÅ² external layer
 - **Height** : 25 mm
 - **Drilling** : traditional
 - **Internal width** : 25 mm
 - **Drilling** : traditional
 - **Internal width** : 25 mm
- Disc brake specific profile
E-Bike specific rim profile
- **ETRTO size 29"** : 622x25TSS
- Hookless profile
- **ETRTO size 29"** : 622x25TSS
- Asymmetrical rim design
- **Tire** : clincher
- UST Tubeless Ready

SPOKES

- **Material** : steel
- **Material** : steel
- **Shape** : straight pull, flat, double butted
- **Shape** : j-bent, round, 2.0 straight gauge
- **Nipples** : aluminum, ABS
- **Count** : 24 front and rear
- **Lacing** : front and rear crossed 2, contactless R2R carbon spoke technology

WHEEL HUB

- Infinity hubs
- **Body** : aluminum
- Instant Drive 360 freewheel technology
QRM Auto bearing preload technology
Hub available with 6-bolt or Center LockÅ® brake rotors
- **Body design** : INFINITY
 - **Disc standard** : 6 Bolts or Center LockÅ®
 - **Axle material** : aluminum
 - **Rear body** : aluminum
 - **Axles** : Front 15X110 (Boost) or 15x100 ; Rear 12X148 (Boost) or 12x142
 - **Rear** : Quick Release, 12x142 and 12x135 compatible
 - **Freewheel** : FTS-L steel

VERSIONS

- **Disc standard** : 6 Bolts or Center LockÅ®
- **Hub width** : Boost only (front 110, rear 148)
- **Freewheel** : SRAM XD, Shimano HG9, Shimano Micro-Spline

WHEEL WEIGHTS

720