

## ASTM CATEGORY 3 : CROSS COUNTRY

For a longer longevity of the wheel, Mavic recommends that the total weight supported by the wheels doesn't exceed 150kg, bike included

Maximum tyre pressure: 4.1bar/59PSI with a 28mm tyre - 2.45bar/36PSI with a 64mm tyre

Recommended tyre sizes: 28 to 64 mm (1.1" to 2.5")

## REFERENCES WHEELS

F92671	CROSSMAX INT 29 BST	F93661	CROSSMAX INT 29
F92681	CROSSMAX CL 29 BST		

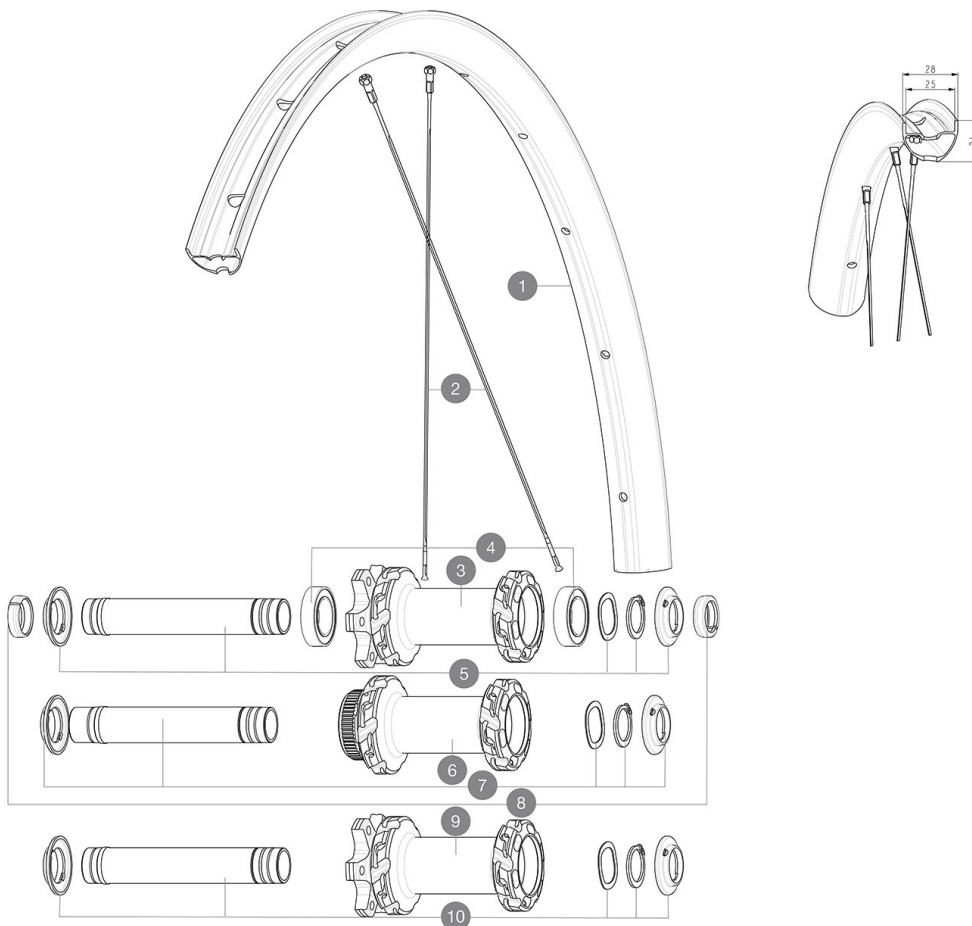

## RIMS



&nbsp;:

1	V3766715 V2700101	Kit Front/Rear rim Crossmax 22 29" UST Tape 28mm for 25 to 27mm wide rims
---	----------------------	--

## SPOKES

2	V2381401	KIT 12 FT/RR BUTTED SPOKES 296mm MTB 29"
---	----------	--

## HUB SHELLS

3	N/A	HUB BODY
4	V2500901	KIT BEARINGS 18x30x7 + WAVED WASHER + CLIP
5	V2372401	KIT 110mm AXLE QRM AUTO MTB > 2019
6	N/A	HUB BODY
7	V2375601	Kit 110mm axle QRM auto MTB from 2019 DCL
9	N/A	HUB BODY
10	V2372301 V2374501	KIT 100mm AXLE QRM AUTO MTB > 2019 KIT 12mm FRT AXLE D6T QRM Auto Allroad 19

## OPTIONS

V2374401	TORQUE CAPS 15*31 Adapter MTB QRM Auto > 2019 FRT HUB
----------	---

## ADAPTERS

8	V2372501 99694101	15mm MTB Axle Cap QRM Auto From 2019 ADAPTER Ft 15 to 9mm QR
---	----------------------	---

# MAVIC CROSSMAX 29

## DELIVERED WITH

UST valve and accessories (129 838 01)	
UST valve and accessories (129 838 01)	
Pre-installed tubeless rim tape	
Pre-installed tubeless rim tape	
User guide	
2 replacement spokes with each wheel	
2 replacement spokes with each wheel	

## COMPATIBILITY

Front axle: convertible from 15mm thru axle to Quick Release with adapters (delivered with non-boost wheel)	
Rear axle: 12mm thru axle, convertible to Quick Release with adapters (delivered with non-boost wheel)	
Freewheel body: convertible SHIMANO HG MTB steel (kit V3790101 sold separately)	
Front axle adapters: 15x100 convertible to 9x100 (kit 99694101 sold separately)	
Front axle adapters: 15x110 convertible to 9x110 (kits 99694101 + V2372501 sold separately)	
Rear axle adapters: 12x148 convertible to 9x141 (kit V2510801 sold separately)	
Instant Drive 360 freewheel technology The new Instant Drive 360 freewheel system is super light and fast to engage with only 9Å°. A large contactless rubber seal provides low friction, while a wide array of end caps makes it super versatile.	
ID360 Sram XD freewheel body (V3740101)	
Front axle: for fixing nuts only (included), M9x1 thread	
Rear axle: for fixing nuts only (included), M9x1 thread	

## Specifications

### RIMS

- **Material** : Mxstal
- **Material** : Mxstal
- **Height** : 21 mm
- **Joint** : SUP welding technology
- **Joint** : SUP welding technology
- **Drilling** : traditional
- **Internal width** : 25 mm
- **Valve hole diameter** : 6.5 mm
- **Drilling** : traditional
- **Internal width** : 25 mm

Disc brake specific profile

E-Bike specific rim profile

- **ETRTO size 29"** : 622x25TSS

Use with Mavic Tubeless Tape

- **ETRTO size 29"** : 622x25TSS

Asymmetrical rim design

- **Tire** : clincher
- UST Tubeless Ready

### SPOKES

- **Material** : steel
  - **Material** : steel
  - **Shape** : straight pull, flat, double butted
  - **Shape** : j-bent, round, 2.0 straight gauge
  - **Nipples** : steel, ABS
  - **Count** : 24 front and rear
  - **Lacing** : front and rear crossed 2
- R2R carbon spoke technology

### WHEEL HUB

Infinity hubs

- **Body** : aluminum

Instant Drive 360 freewheel technology

QRM Auto bearing preload technology

- **Axles** : Front 15X110 (Boost) or 15x100 ; Rear 12X148 (Boost) or 12x142

Hub available with 6-bolt or Center LockÅ® brake rotors

- **Body design** : INFINITY

- **Disc standard** : 6 Bolts or Center LockÅ®

- **Axle material** : aluminum

- **Rear body** : aluminum

- **Axle size** : front 15x100 / rear 12X142 -

Convertible to quick release with included adapters

- **Axles** : Front 15X110 (Boost) or 15x100 ; Rear 12X148 (Boost) or 12x142

- **Freewheel** : Shimano HG MTB / Shimano MS / Sram XD MTB

- **Freewheel** : FTS-L steel

### VERSIONS

- **Disc standard** : 6 Bolts or Center LockÅ®

- **Hub width** : Boost (front 110, rear 148) or Non-Boost (front 100, rear 135/142) 6 bolts

- **Freewheel** : SRAM XD, Shimano HG9, Shimano Micro-Spline

### WHEEL WEIGHTS

820