

REFERENZEN RÄDER

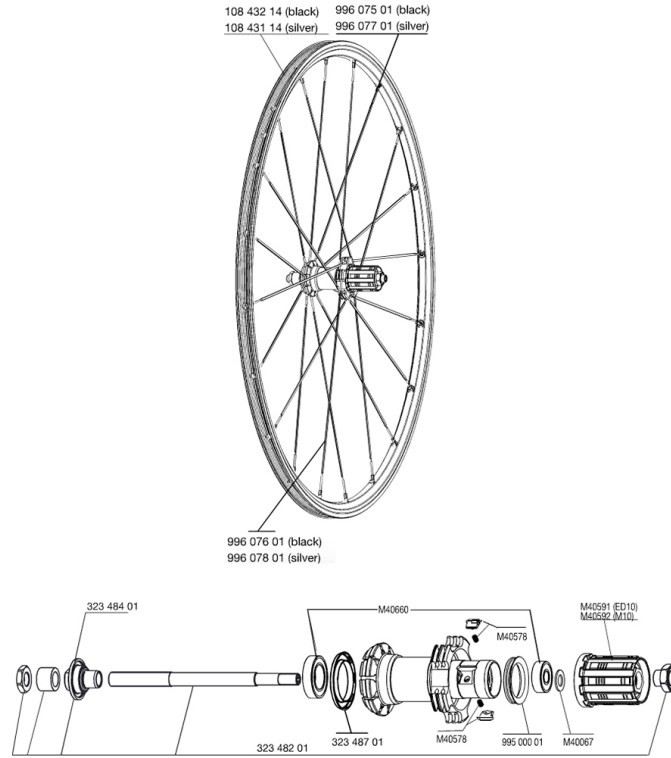

RIMS



&NBSP;:

| | |
|----------|-----------------------------|
| 10843214 | FR/RE.BLACK RIM AKSIUM 010 |
| 10843114 | FR/RE.SILVER RIM AKSIUM 010 |

SPOKES

| | |
|----------|-----------------------------|
| 99607801 | DRV SIL.SPK.AKSIUM 08 305mm |
| 99607501 | F/NDR BLK SPK.AKSIUM 08 282 |
| 99607701 | F/NDR SIL.SPK.AKSIUM 08 282 |
| 99607601 | DRV BLK SPK.AKSIUM 08 305mm |

HUB SHELLS

| | |
|----------|----------------------------------|
| 32348701 | HUB CAP XMAX END/KSY EQ/COSMOS |
| M40660 | REAR HUB 608+6001 BEARINGS |
| M40591 | CORPS DE ROUE LIBRE FTS "L" ED10 |
| 32348401 | EXPANSIBLE BEARINGS SUPPORT |
| 99500001 | FTSL/FTSX FREEHUB BODY SEAL |
| M40578 | FTSL PAWLS KIT (ROAD WHEELS) |
| 32348201 | REAR AXLE COSMOS II/KSYRIUM EQ |
| M40592 | CORPS DE ROUE LIBRE FTS "L" M10 |
| M40067 | 10 SPACERS FRW/HUB BODY |

MAVIC *AKSIUM 08*

Specifications

RADGEWICHTE